

Included in the package



--> Front Splitter

--> 14 X Screws



ABS

! We highly recommend having your products installed by a specialist.

Installation



Screwdriver - Masking Tape - Cloth - Pencil

Resources
needed!



At least two people



Around 40 min

Centering

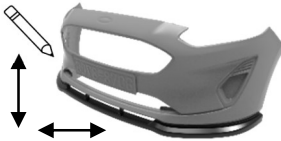

Center the splitter on the car's bumper to find the right place for the product to be installed. Use a pencil to draw an outline on the surface of the car around the product's edges. This will be used as an installation driver.

Cleaning

Clean the car's surface and the splitter with cleaner. Let the surfaces dry.



Optional: Apply silicone over the product's surface that attaches to the car. Then, re-center the splitter following the drawn outline from the previous step.

Apply silicone

! Excessive silicone could overflow and become visible once the splitter is attached.

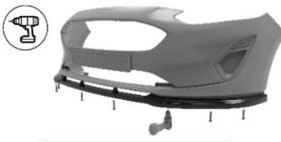

Attaching

Carefully place the splitter on the car, following the marked outline, and attach the screws to their contact points. Screw the bolts while holding the splitter to the right place.

Detailed attaching instructions

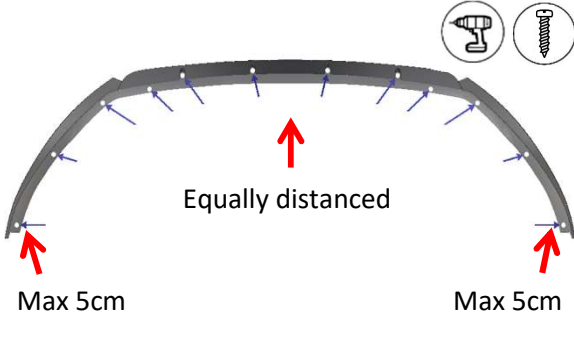
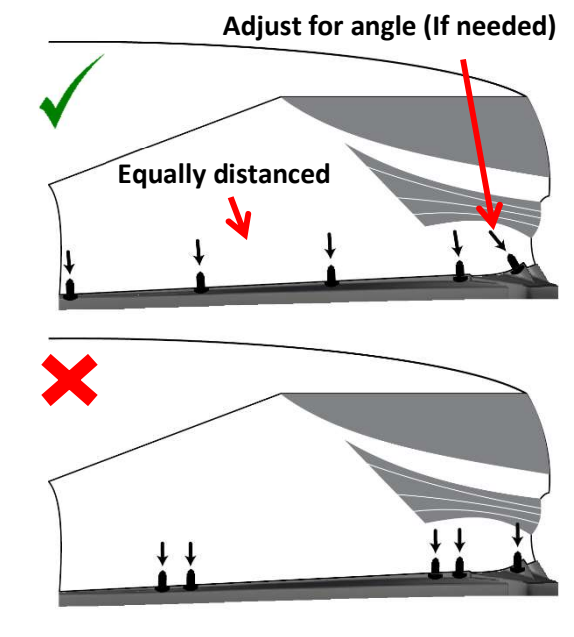
 <p>Equally distanced</p> <p>Max 5cm</p> <p>Max 5cm</p>	<p>We recommend:</p> <p>--> Using 4 screws at each side of the product with the first screw not being more than 5cm away from the edge of the product.</p> <p>--> Using 4 - 6 screws at the center of the product.</p> <p>--> At the front side of the splitter, you should drill at the correct angle and relatively closer to the front edge of the splitter, according to the design of the product. The screws should be equally distanced from each other.</p>
<p>Adjust for angle (If needed)</p>  <p>Equally distanced</p>	

Vehicle Use

The vehicle is now ready to be used.

For any queries, please contact us at:
+30 210-5596681-3
info@motordromedesign.com

